

QA115LSE



QA115LSE

PRODUCT SPECIFICATION

QA115LSE

Materials Lens-PC, Housing-PC

Ambient operating temperature -30°C to +50°C

Protection rating IP66

Vibration resistant and shock-proof

can withstand 15g of vibration and 50g of shock

- Strong signal light emission in outdoor environment with strong sunlight by applying special LED diffusion system
- Ability to compensate for signal attenuation phenomenon that occurs during daytime operation with a powerful xenon lamp.

QA115LSE LED Strobe Beacons

Model number	Voltage	Current	Certificates	Weight	Color
QA115LSE	DC12V-24V	Max.1A	CE	1.01kg	● A-Amber

· Flashing rate: 60-80 flashes/min, Outer diameter: 115mm

※ DC type model has a free-voltage range of 10V-30V.

Technical Diagram

Units: mm

·QA115LSE

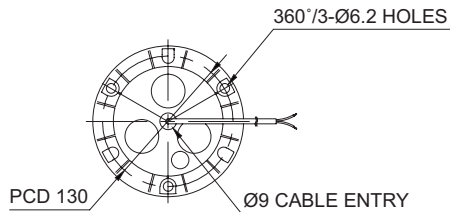
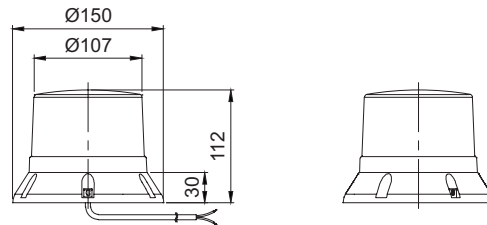

Wiring Instructions

- External power line
UL2464 18AWG x 2C 400mm
- This product can be wired regardless of polarity.

Customization

- Connector type wiring products
- Built-in protection cage

Ordering Specification

QA115LSE	-	12/24	-	A
[Model number]		[Voltage]		[Color]
QA115LSE		12/24-DC12V-24V		● A-Amber