

# QA85LSE



QA85LSE

## PRODUCT SPECIFICATION

QA85LSE

**Materials** Lens-PC, Housing-ABS+PC

**Ambient operating temperature** -30°C to +50°C

**Protection rating** IP65

**Flashing rate** LED flash type: 60-80 flashes/min  
 LED strobe type 1: 60-80 flashes/min  
 LED strobe type 2: 40-60/min

- Ultra-high brightness LED strobe light for heavy equipment that maximizes light efficiency by applying a special diffused lens
- Emit strong signal light like xenon lamp by compensating for the signal light attenuation that occurs during the day
- Various functions of steady-flash-strobe are available

### QA85LSE LED Strobe Beacons

Model number	Voltage	Operation mode	Current	Flashing rate	Certificates	Weight	Color
QA85LSE	DC12V-24V	steady	Max.150mA	-	-	0.16kg	● R-Red ● A-Amber ● G-Green ● B-Blue
		flashing	Max.330mA	60-80/min			
		Strobe1	Max.180mA	60-80/min			
		Strobe2	Max.180mA	40-60/min			

※ DC type model has a free-voltage range of 10V-30V.

### Technical Diagram

Units: mm

·QA85LSE

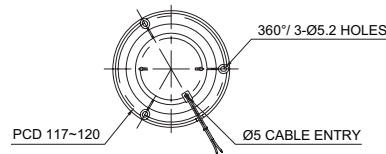
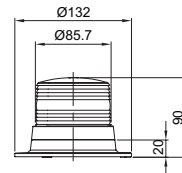

### Wiring Instructions

- External power line UL2464 20AWG x 2C 400mm
- DC Type: Black output line is negative(-).

### Customization

- User selected connector type available upon request

### Ordering Specification

QA85LSE	-	12/24	-	R
[Model number]		[Voltage]		[Color]
QA85LSE		12/24-DC12V-24V		● R-Red ● A-Amber ● G-Green ● B-Blue