

# EMCL Series



## PRODUCT SPECIFICATION

EMCL30 | EMCL50  
EMCL70 | EMCL90

**Materials** Housing-Al, Lens-PC  
**Ambient operating temperature** -25°C to +55°C  
**Volume** Max. 85dB at 1m  
**Protection rating** IP69K

- Small indicator light capable of transmitting three signal colors with one indicator light
- By applying a milky translucent lens, the unique color of the LED is emitted subtly when turned on
- Respond to customer needs with various outer diameters (30mm, 50mm, 70mm, 90mm) and designs
- Waterproof and dustproof model with fully sealed structure with IP69K degree of protection to cope with harsh environmental conditions
- Buzzer specifications can be selected for signal wire withdrawal type or M12 connector mounting type

### EMCL Series Industrial LED beacon

Model number	Voltage	Current	Certificates	Weight	Color		
EMCL30 Steady	DC24V	0.040A	CE	0.05kg	<span style="color:red">●</span> R-Red <span style="color:yellow">●</span> A-Amber <span style="color:green">●</span> G-Green		
EMCL30-BZ Steady w/built-in buzzer							
EMCL50 Steady				0.061A		0.09kg	
EMCL50-BZ Steady w/built-in buzzer							
EMCL70 Steady						0.16kg	0.21kg
EMCL70-BZ Steady w/built-in buzzer							
EMCL90 Steady							
EMCL50-EMCL90-BZ Steady w/built-in buzzer							

### Bracket

It can be installed on the wall by adopting wall mounting type bracket.



### Wiring Instructions

#### • EMCL Series

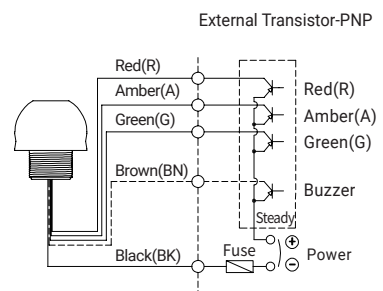
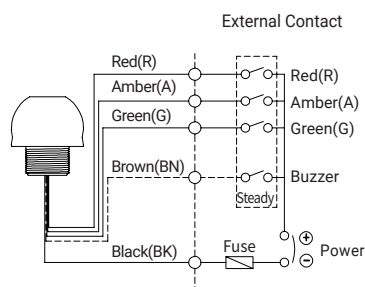

## Technical Diagram

Units: mm

### • EMCL30 / EMCL30-BZ

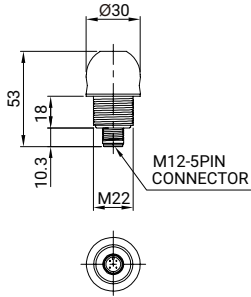

### • EMCL50 / EMCL50-BZ

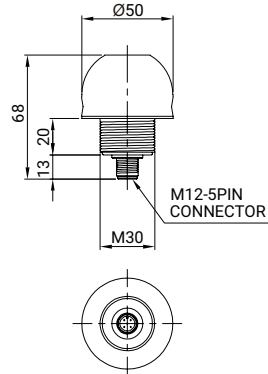

### • EMCL70 / EMCL70-BZ

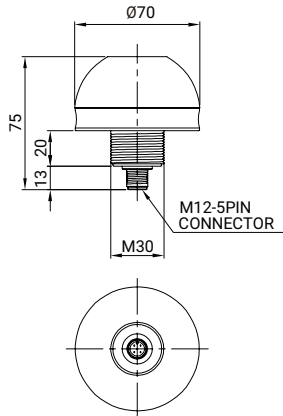

### • EMCL90 / EMCL90-BZ

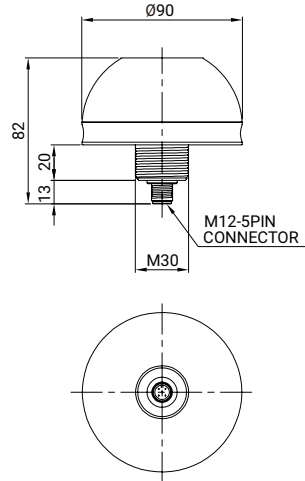

EMCL70



EMCL90

## Customization

- M12 Five- Core Cable/1.5m
- NPN type

## M12 connector type

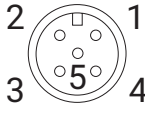
5PIN CONNECTOR	No.	Color	Wiring
	1	RED	Pin 1
	2	AMBER	Pin 2
	3	GREEN	Pin 3
	4	Common	Pin 4
	5	Buzzer	Pin 5

## Ordering Specification

EMCL30	-	24	-	RAG	-	M12
[Model number]		[Voltage]		[Color]		[Cable]
EMCL30 EMCL30-BZ EMCL50 EMCL50-BZ EMCL70 EMCL70-BZ EMCL90 EMCL90-BZ		24-DC24V		● R-Red ● A-Amber ● G-Green		None-External contact M12-M12 connector type